

GSCH40

Smart Battery Charger

P/N: -

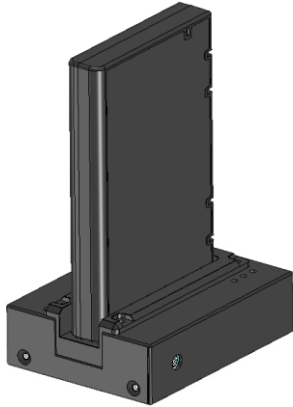

Feature

- Wide range voltage input.
- Compliant with SMBus specification, compatible with all TEFOO smart batteries.
- Efficient and fast charging.
- Meet JEITA charging rules.
- Complete safety protection functions, such as over charging, over discharging, over current, over temperature, short circuit, etc.

Application

Suitable for portable electronic equipment, industry and medical field.

Overview

Input interface	2.1φx5.5φDC
Output Interface	5PIN Blade smart battery interface
Operate temperature	-30°C~70°C
Charge temperature	0°C~50°C

Electrical performance

Input voltage	9-24VDC (The input voltage should be higher than 1V of the standard battery charging voltage)
Input power	≥60W
Output voltage	0-16.8V (Suitable for 2~4 series Smart battery packs)
Charging current	0-4A
Maximum output power	50.4W
Charging efficiency	> 85%
Safety certification	CE/FCC

Dimensions

Length	111.0mm ± 0.3mm
Width	84.0mm ± 0.3mm
Height	35.0mm ± 0.3mm
Weight	TBD

LED instruction

Power on	Blue light is always on
Charging	Green light flashing
Fully charged	Green light is always on
Failure	Red light is always on

Recommended adapter (Optional)

Model	GSP19V065W55210
Rated voltage /current	19V/3.42A
Rated Power	65.0W